

SMD Power Inductor

CDB38D38



特点

- Ferrite core construction
- Magnetically shielded
- L×W×H: 4.0×4.0×4.0mm Max.
- Product weight: 0.25g(Ref.)
- Moisture Sensitivity Level: 1

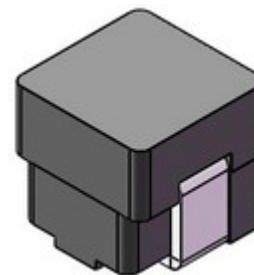

环境规格

- Operating temperature range: -40°C~+125°C (including coil's self temperature rise)
- Storage temperature range: -40°C~+125°C

包装

- Carrier tape and reel packaging
- 1500pcs per reel

用途

- Multi-phase and Vcore regulators
- Voltage Regulator Modules (VRMs), such as server and desktop, Central processing unit (CPU), Graphics processing unit (GPU), Application specific integrated circuit (ASIC), high power density, data networking density, graphics cards and battery power systems

外形尺寸 - [mm]

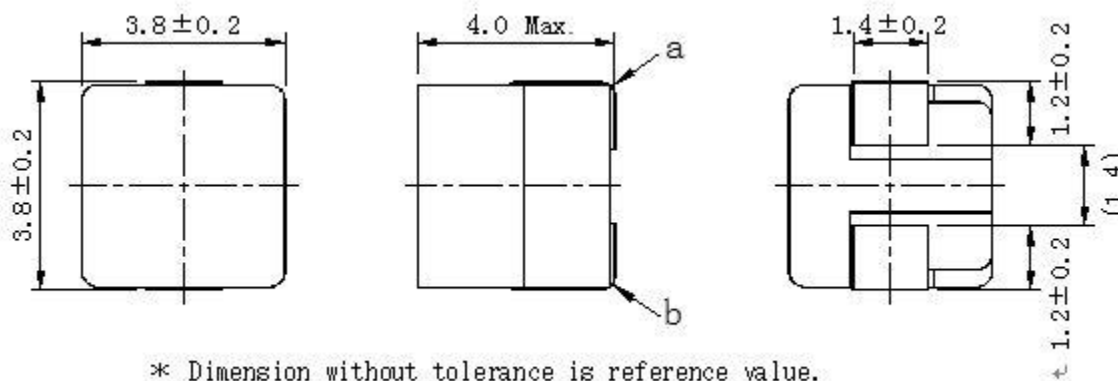

- * Dimension without tolerance is reference value.
- * The DCR is measured from point "a" to "b".

SMD Power Inductor

CDB38D38



推荐焊盘尺寸 - [mm]

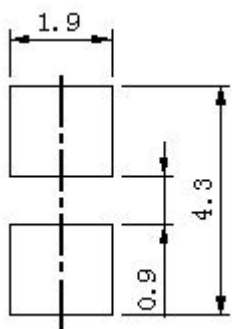

接线图 (底面)

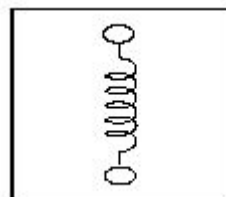



电气特性规格

品名	电感值 [within] (μ H) ※1	直流电阻 (20℃) Max. (Typ.) (m Ω)	饱和电流 (A) Max. (Typ.) ※2		温度上升电流 (A) Max. (Typ.) ※3
			20℃	125℃	
CDB38D38NP-R065MC	0.065 \pm 20%	0.35 (0.32)	24.50 (29.00)	18.50 (22.00)	(24.00)
CDB38D38NP-R10PC	0.10 \pm 25%	0.35 (0.32)	14.50 (17.00)	11.90 (14.00)	(24.00)

※1 Measuring frequency inductance at 1MHz.

※2 Saturation current: This indicates the value of D.C. current when the inductance becomes 20% lower than its initial value.

※3 The temperature rise: the actual value of DC current when the temperature rise is $\Delta t=40^{\circ}\text{C}$ ($T_a=20^{\circ}\text{C}$).

回流焊耐热与推荐温度曲线图

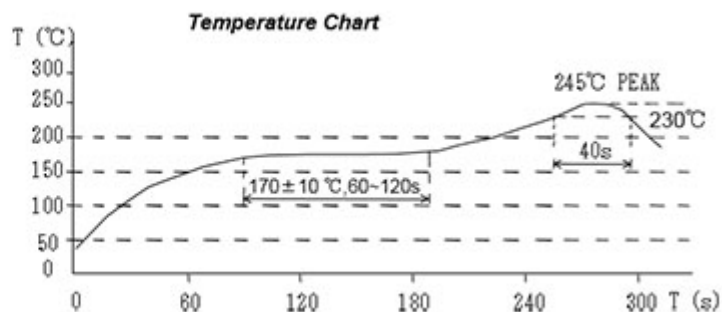
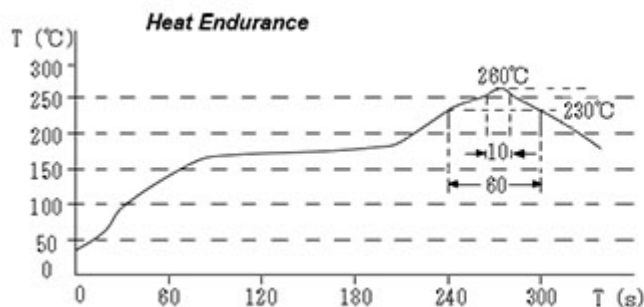

SMD Power Inductor

CDB38D38



直流饱和电流&温度上升曲线图

— L (20°C) — L (45°C) — L (100°C) — L (125°C) — ΔT

1. CDB38D38NP-R065MC

2. CDB38D38NP-R10PC

L (μH) ΔT (°C)

L (μH) ΔT (°C)

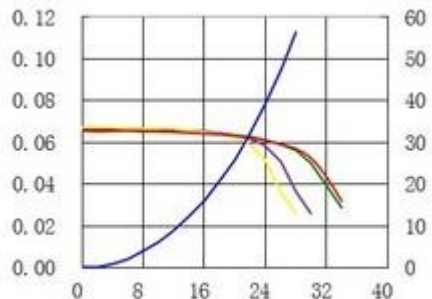

DC(A)

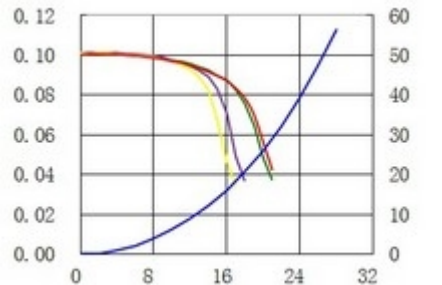

DC(A)



有关销售办事处的信息，请 [点击这里](#)。